

LEAD CUT  
LESS THAN 3mm

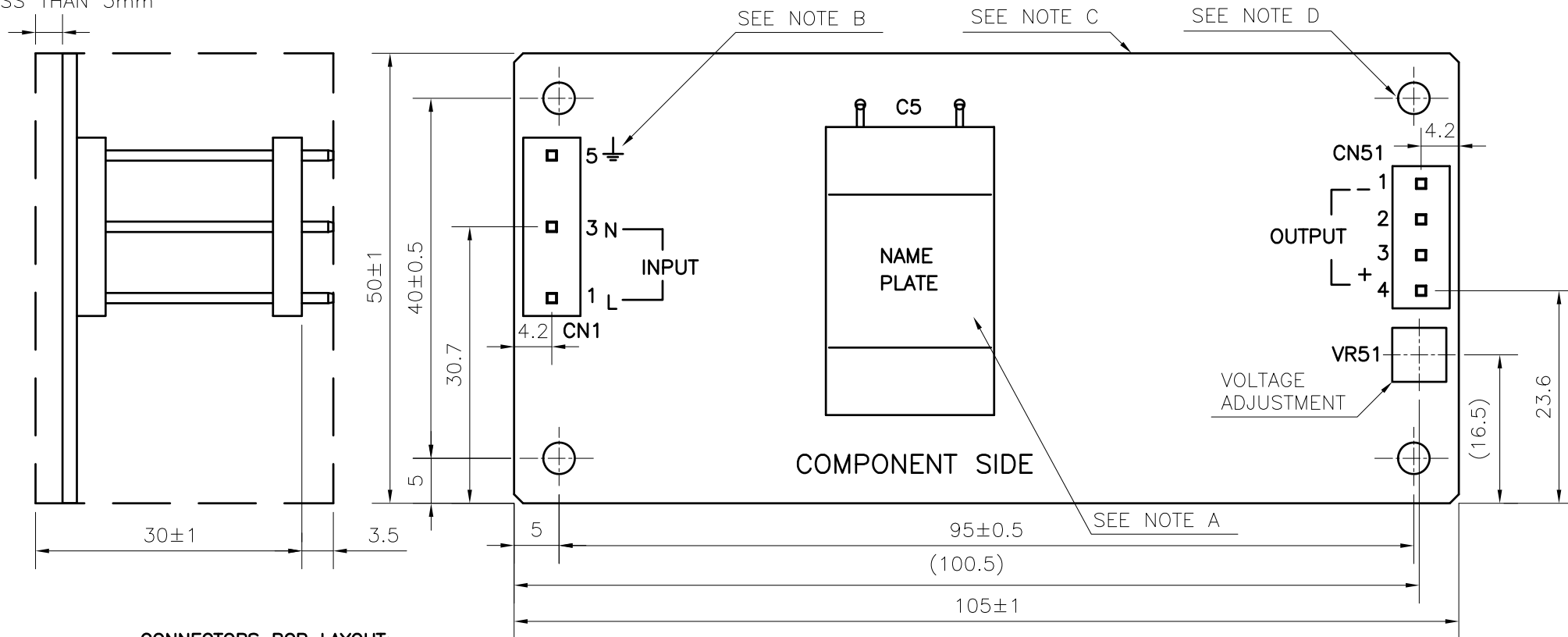

**CONNECTORS PCB LAYOUT:**

**1. INPUT CONNECTOR**

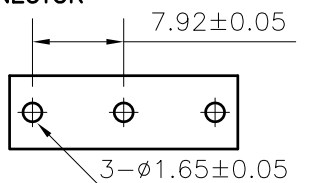

**2. OUTPUT CONNECTOR**

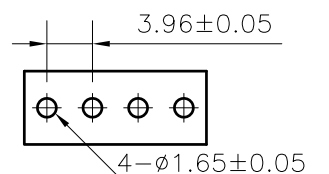

**NOTES**

- A: MODEL NAME, INPUT VOLTAGE RANGE, NOMINAL OUTPUT VOLTAGE, NOMINAL OUTPUT CURRENT, PEAK OUTPUT CURRENT AND SAFETY MARKING(FOR ONLY APPROVED PRODUCTS)ARE SHOWN ON THE NAME PLATE IN ACCORDANCE WITH THE SPECIFICATIONS. COUNTRY OF MANUFACTURE WILL BE SHOWN ON THE NAME PLATE.
- B:  $\perp$  IS FOR SAFETY GROUND CONNECTION.
- C: TO KEEP THE DISTANCE MORE THAN 4mm BETWEEN PC-BOARD EDGE AND CUSTOMER'S CHASSIS.
- D: THE 4-∅3.5 HOLES ARE CUSTOMER CHASSIS MOUNTING HOLES. IF THE APPLICATION FACE CRITICAL VIBRATION, CUSTOMER SHOULD USE FOUR STANDOFFS TO FIX POWER SUPPLY. DETAILS PLEASE REFER TO INSTRUCTION MANUAL.

(unit : mm)

MODEL NAME	CUS30E
<b>TDK-Lambda</b>	

CA808-02-01A